

*W. Watwick,
Coffee Mill.*

No. 11,845.

Patented Oct. 24. 1854.

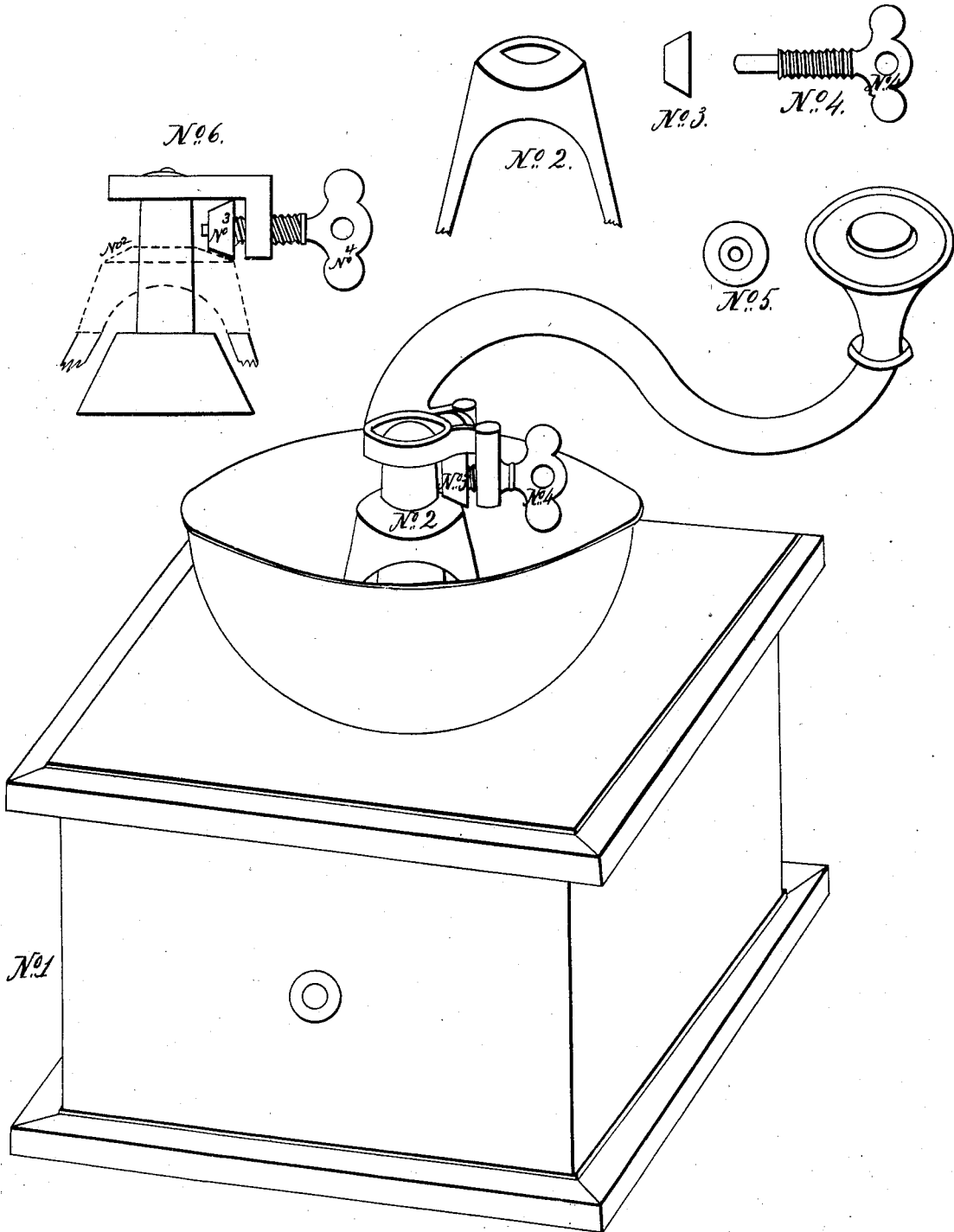

UNITED STATES PATENT OFFICE.

WM. WARWICK, OF BIRMINGHAM, PENNSYLVANIA.

MILL.

Specification of Letters Patent No. 11,845, dated October 24, 1854.

To all whom it may concern:

Be it known that I, WILLIAM WARWICK, of the borough of Birmingham, in the county of Allegheny and State of Pennsylvania, have invented a new and Improved Mode of Regulating and Cutting of Mills for Grinding Purposes; and I do hereby declare that the following is a full, clear, and exact description of the construction and operation of the same, reference being had to the accompanying drawing, making a part of the specification.

Figure No. 1, represents a grinding mill complete. Fig. No. 2, is the shell to represent on its top the beveled track upon which the roller Nos. 3 and 5 travels. Fig. No. 3, is a side view of the traveling wheel. Fig. No. 4, is the thumb screw, with a journal on its end, on which the traveling wheel revolves. Fig. No. 5, is a front view of the traveling wheel.

The nature of my invention consists in the insertion of a traveling wheel or anti-friction roller (as seen in Fig. Nos. 3 and 5) graduated by pressure upon the handle of the mill and regulating the cut of the mill by its action upon a beveled track as seen in Fig. No. 2, the action conducted at pleasure up and down the track by means of a thumb screw as seen in Fig. No. 4.

The advantages of my arrangement are, 1st, the saving of friction by means of the roller, by which the effort and labor required in its use is lessened very greatly; 2nd, the strength and durability of the mill is augmented, as the pressure upon the handle is received upon the bur and shell and not as heretofore in mills, and the heavier the pressure the smoother the travel; 3d, by this arrangement the bur will wear equally true on all sides, and consequently the material ground will be of equal fineness.

What I claim as my invention and desire to secure by Letters Patent, is—

1. The mode of regulating the cut of grinding mills by the insertion of a traveling wheel or anti-friction roller, in combination with the beveled track on which the roller travels.

2. I also claim as original the position of the thumb screw (Fig. No. 4), it being parallel with the handle, and not as in other mills, perpendicular with the cutting bur and shell, also its use as a journal for the traveling roller.

WILLIAM WARWICK.

Witnesses:

ANDREW McMASTER,
ANDREW LONG.